



Aalborg MD

Multi-purpose heat exchanger in noble materials



Aalborg MD coolers and condensers are shell and tube heat exchangers applicable as dump condensers, drain coolers or oil coolers. The straight tube design condenser in extremely durable materials is available in designs for either atmospheric or pressurized operation (up to 16 bar(g)).

Description

The Aalborg MD tank washing heat exchanger is designed for horizontal installation and an operating pressure of 16 bar(g) and eliminates the need for sacrificial anodes.

The externally sealed floating head tube sheet of the straight tube coolers/condensers compensates for thermal expansion. The design conditions for the shell and tube side are 16 bar(g)/204°C and 16 bar(g)/100°C respectively.

The capacity range of the Aalborg MD cooler is 400 – 6,000 kg/h steam at 3 bar(g)/157°C is subcooled to 80°C with 32°C seawater.



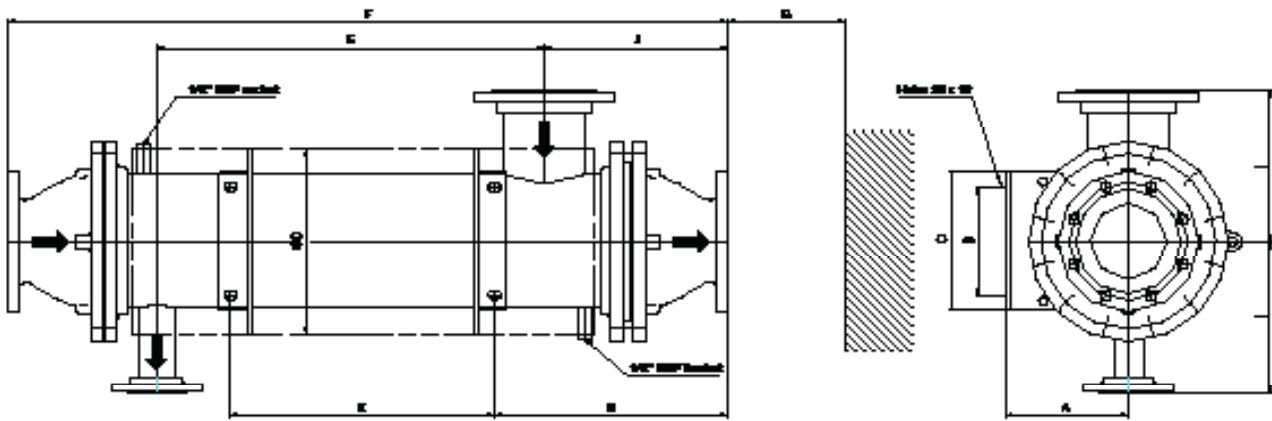

Standard product range

Capacity and dimensions

Type	A	B	C	ØD	E	F	G	H	I	J	K
MD15	200	220	270	270	L - 275	L + 233	L - 100	360	254	281	Acc. to dimension dwg
MD20	250	220	280	325	L - 290	L + 285	L - 100	400	280	319	Acc. to dimension dwg
MD25	250	220	280	380	L - 314	L + 363	L - 100	475	307	374	Acc. to dimension dwg
MD30	250	220	280	425	L - 349	L + 385	L - 100	540	332	411	Acc. to dimension dwg
MD40	350	300	300	610	1555	1940	2100		375	635	1200
MD50	450	350	300	715	2470	4260	3100		425	820	193

L is the length of straight tubes

Nozzles	MD15	MD20	MD25	MD30		
Sea water inlet	N1	DN100	DN125	DN150	DN200	Fixed size
Sea water outlet	N2	DN100	DN125	DN150	DN200	Fixed size
Steam inlet	N3	DN100	DN125	DN150	DN200	Max. size
Condensate outlet	N4	DN40	DN40	DN50	DN65	Max. size
Inlet for drain cooling (optional)	N5	DN100	DN125	DN150	DN200	Max. size

Standard programme – weights in kg

Type/Length	600	750	850	1000	1200	1500	1800	2000
MD15	93	99	104	110	119	132	143	151
MD20	137	148	155	166	180	202	220	234
MD25	209	226	238	255	279	314	339	360
MD30	277	302	319	343	377	426	461	480

Design pressure shell/tubeside: 16/16 bar(g)

Design temperature shell/tubeside: 204/100°C

Flanges: JIS-16K/EN1092-1 PN16

Mounting style: Horizontally or vertically

MDD00243EN 1507

How to contact Alfa Laval

Contact details for all countries are continually updated on our website. Please visit www.alfalaval.com or e-mail to aalborgheaters@alfalaval.com to access the information.